

A RESOLUTION AUTHORIZING AND DIRECTING THE CLERK OF THE COUNCIL TO ADVERTISE FOR PUBLIC HEARING ON OCTOBER 9, 2012, THE ANNEXATION OF AN AREA REFERRED TO AS CAMBRIDGE SQUARE, TAX MAP PARCEL NO. 132A-A-026, IN HAMILTON COUNTY, TENNESSEE, AS DESCRIBED HEREIN BELOW AND AS SHOWN ON THE ATTACHED MAP, CONTIGUOUS TO THE CITY LIMITS OF CHATTANOOGA.

---

BE IT RESOLVED BY THE CITY COUNCIL OF THE CITY OF CHATTANOOGA, TENNESSEE, That the Clerk of the Council is hereby authorized to advertise for public hearing on October 9, 2012, the annexation of a tract of property located in Hamilton County, Tennessee, which tract is contiguous to the City and is more fully described as follows:

**CAMBRIDGE SQUARE**

**Proposed Annexation Area**

Being a portion of the W. L. Hall's Subdivision as shown in Plat Book 15, Page 35 (ROHC), Registers Office Hamilton County Tennessee and more particularly described as follows:

To find the TRUE POINT OF BEGINNING, begin at the eastern most corner of Lot 1, Final Plat of Ooltewah Church of Christ's Resubdivision, Lot 1, as shown in Plat Book 35, Page 388 ROHC; thence along the northern line of said lot 1 N 66-58-38 W, a distance of 227.11 feet to a point being 42.89 feet southeast of the northern most corner of lot 1 being the TRUE POINT OF BEGINNING; thence N 66-58-38 W, a distance of 42.89 to said corner; thence N 66-45-33 W, a distance of 224.91 feet to a point; thence S 23-16-12 W, a distance of 58.31 feet to a point; thence N 66-43-48 W, a distance of 116.26 feet to a point; thence N 23-01-08 E, a distance of 96.22 feet to a point; thence S 66-53-05 E, a distance of 384.32 feet to a point; thence S 23-01-08 W, a distance of 38.65 feet to the TRUE POINT OF BEGINNING. Containing 0.49 acres more or less.

Tax Map Parcel No. 132A-A-026

ADOPTED: September 4, 2012.

KOF/mms

**NOTICE**

The City Council of the City of Chattanooga, Tennessee will hold a public hearing in the Assembly Room at City Hall on Tuesday,

**October 9, 2012**

at 6:00 p.m. for the purpose of hearing any person whose property may be affected by, or who may otherwise be interested in the proposed annexation of certain territory in the Third Civil District of Hamilton County, Tennessee, being Tax Parcel No. 165-001 owned by Barrier Properties LLC, [d/b/a Cambridge Square], lying contiguous to the present corporate limits, as shown on the attached map.

This the \_\_\_\_\_ day of \_\_\_\_\_, 2012.

---

Carol K. O'Neal  
Clerk of the City Council

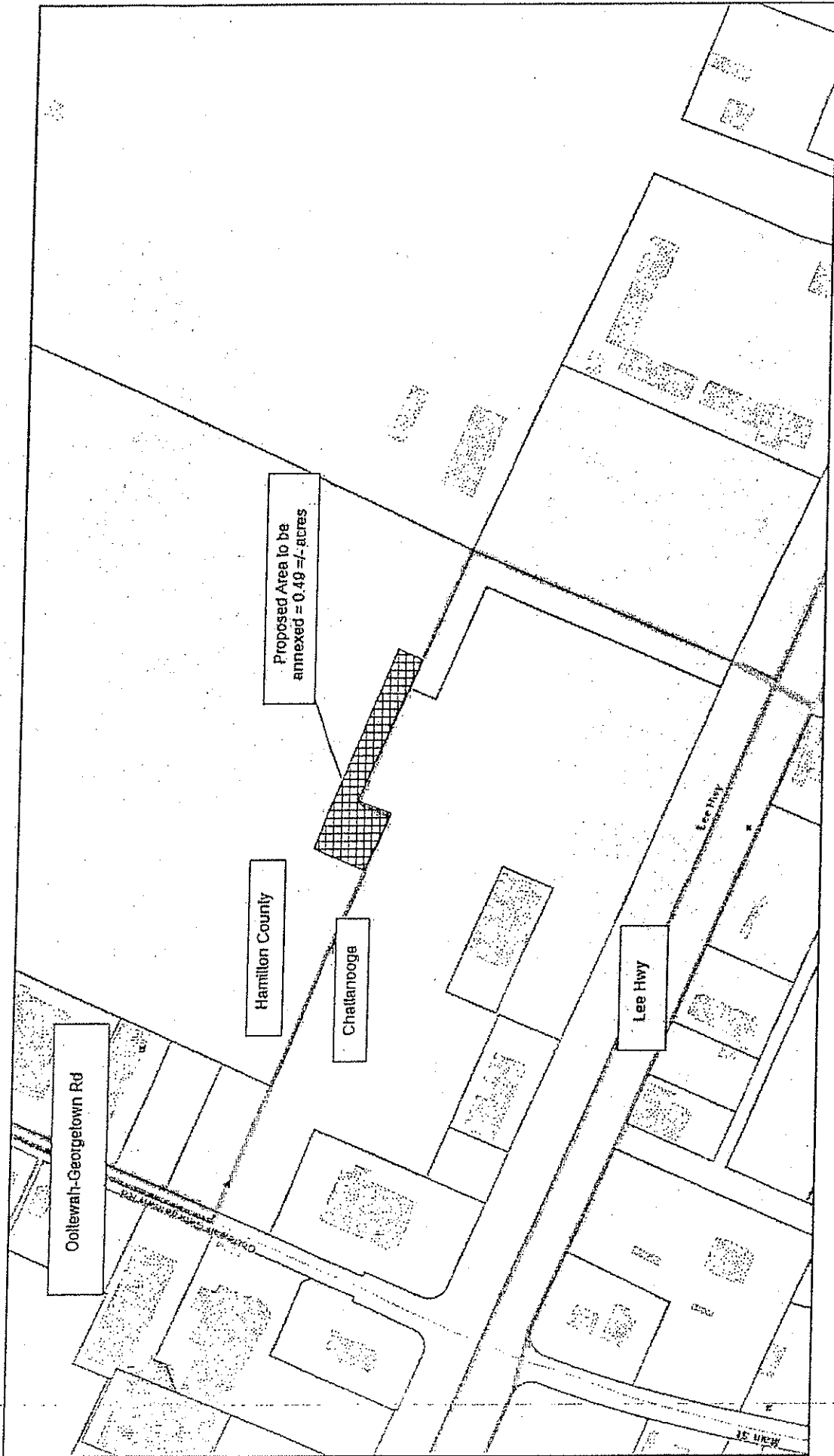

August 2, 2012

# Cambridge Square Annexation Area



260 ft

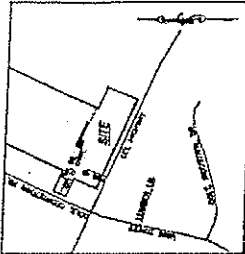

Vicinity Map  
N.E.A.

EX. IMPROVEMENT  
MATERIAL  
EXISTING

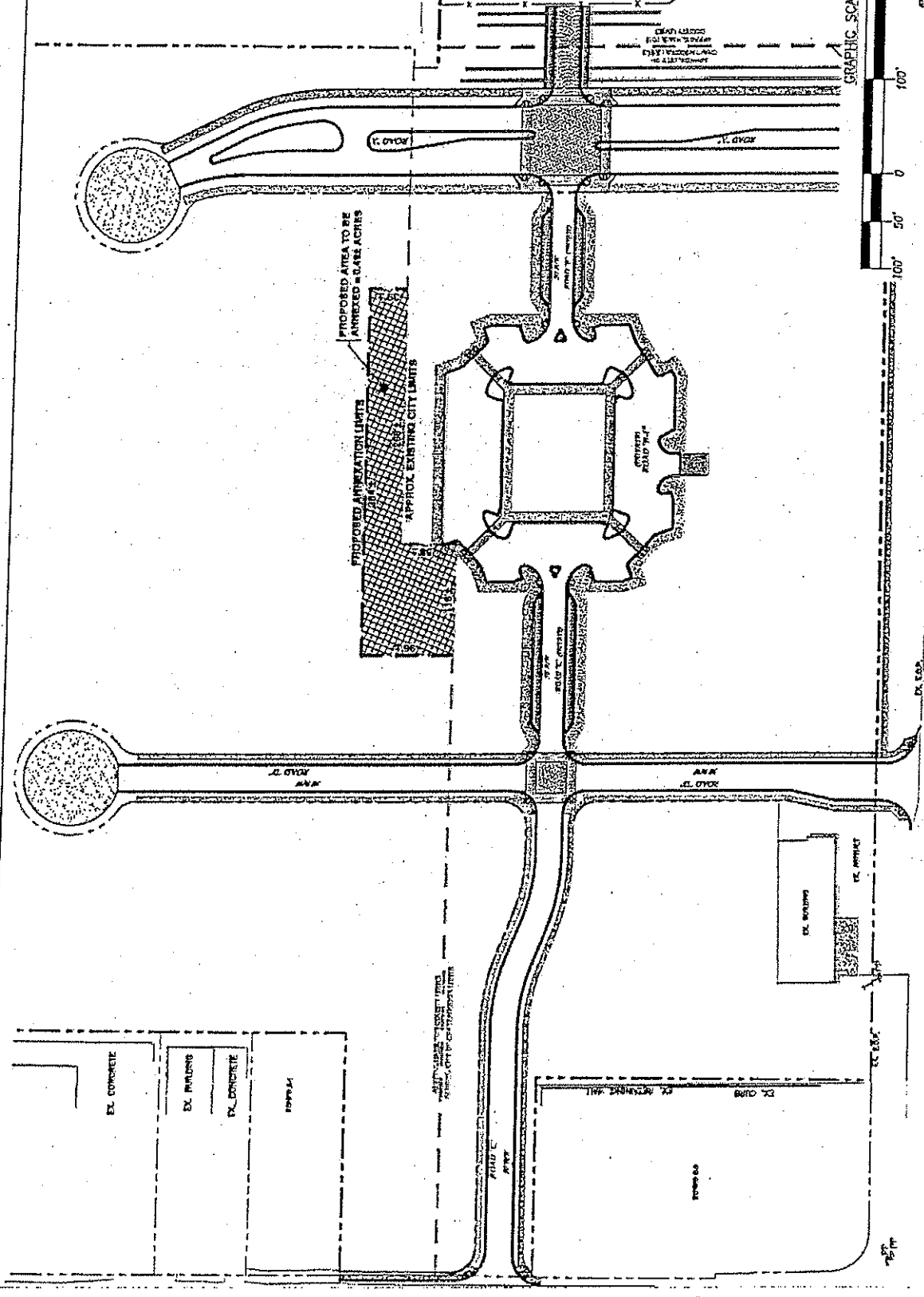

GRAPHIC SCALE



© COPYRIGHT 2012 MAP ENGINEERS, LLC

TEL: (408) 685-8854  
FAX: (408) 465-8110

# MAP ENGINEERS

7360 Applegate Ln.  
Chattanooga, TN 37421

ALL RIGHTS RESERVED  
This drawing is the property of  
Map Engineers, LLC. It is to be used  
only for the project and site to which  
it applies. No part of this drawing  
may be reproduced, stored in a  
retrieval system, or transmitted in  
any form or by any means, without  
the prior written permission of the  
Engineer.

LEG HIGHWAY

EX. CONCRETE  
EX. PAVING  
EX. CONCRETE  
PROP. LA

EX. IMPROVEMENT  
MATERIAL  
EXISTING

EX. CONCRETE  
EX. PAVING  
EX. CONCRETE  
PROP. LA

EXISTING IMPROVED PAVEMENT

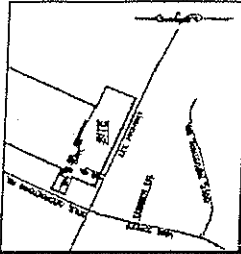

PROPOSED AREA TO BE ANNEXED = 0.49± ACRES

PROPOSED ANNEXATION LIMITS

APPROX. EXISTING CITY LIMITS

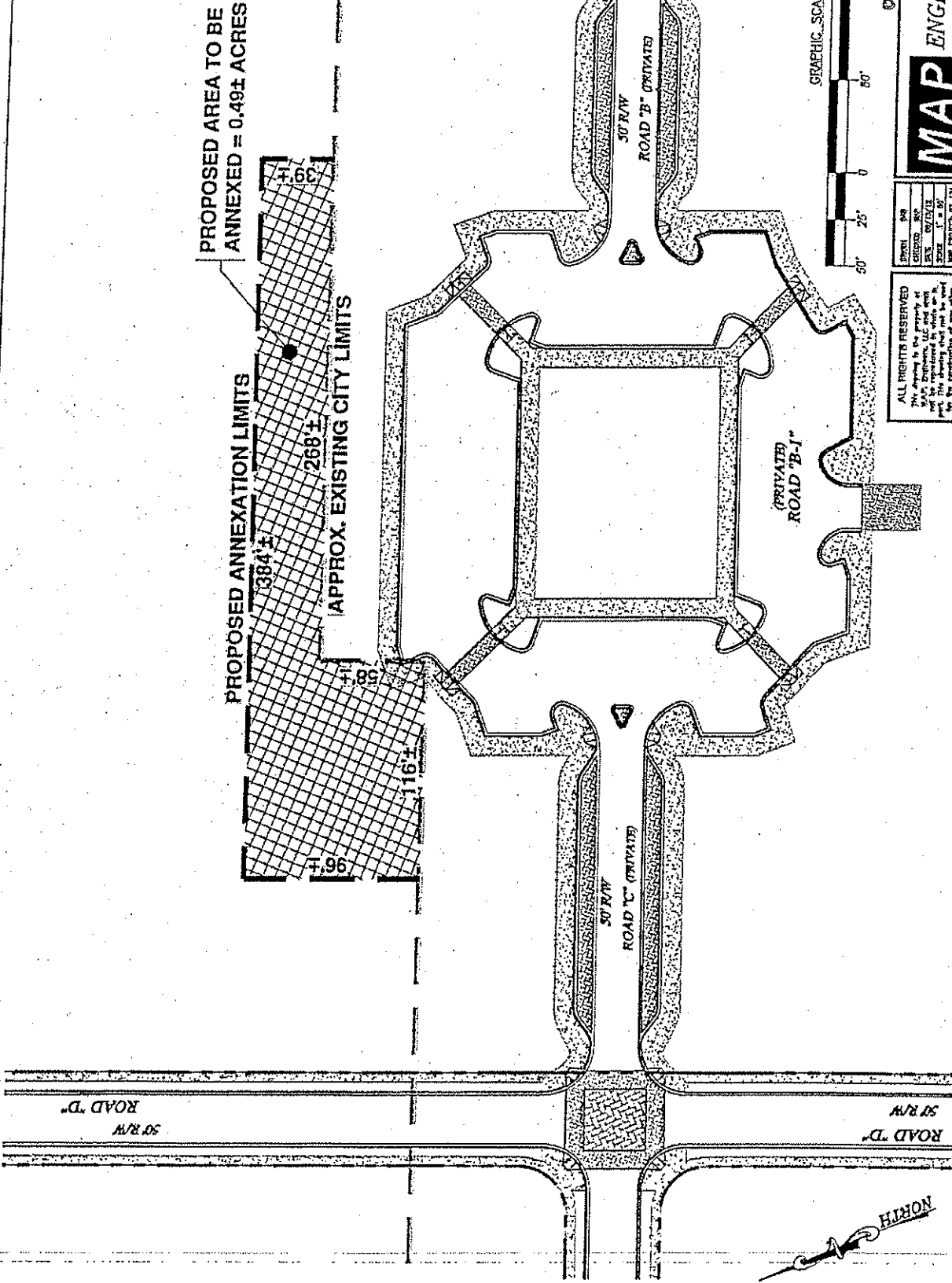

GRAPHIC SCALE



© COPYRIGHT 2008 MAP ENGINEERS, LLC

Tel: (423) 852-6554  
Fax: (423) 485-8110

**MAP ENGINEERS**

2000 Applegate Ln.  
Chattanooga, TN 37421

PROJECT	208
SHEET NO.	804
DATE	04/15/14
SCALE	1" = 50'
APP. PROJECTED BY	BT-131

ALL RIGHTS RESERVED  
This drawing is the property of  
Map Engineers, LLC and shall  
not be reproduced, copied, or  
used in any way without the  
written consent of the author.  
The construction of any other  
project without the written  
consent of the engineer.

